

# ○ 神田校舎 1～3号館 地下3階～地下1階 ○

## ● 地下3階 ●

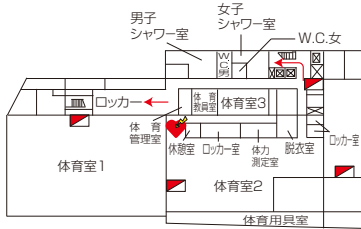

## ● 地下2階 ●

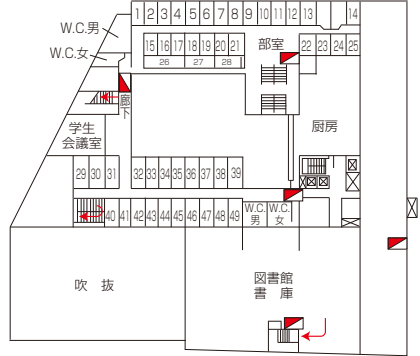

## ● 地下1階 ●

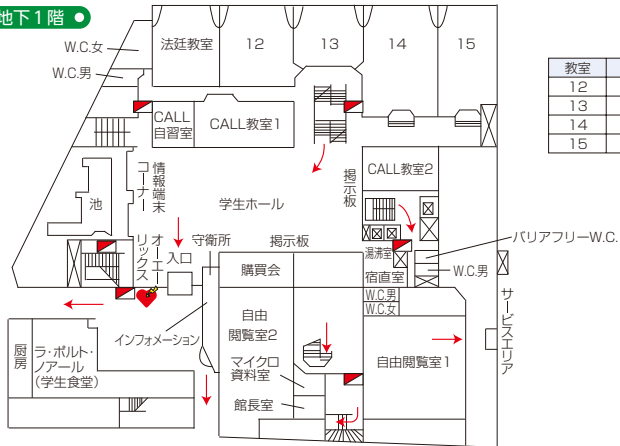

# 神田校舎 1～3号館 1階～3階

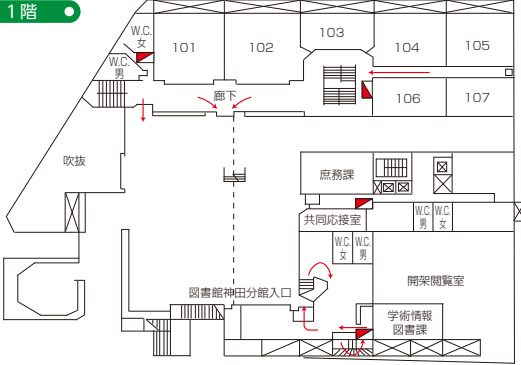

| 教室  | 定員  |
|-----|-----|
| 101 | 180 |
| 102 | 168 |
| 103 | 56  |
| 104 | 96  |
| 105 | 108 |
| 106 | 90  |
| 107 | 90  |
| 201 | 132 |
| 202 | 132 |
| 203 | 72  |
| 204 | 132 |
| 205 | 132 |
| 206 | 72  |
| 207 | 72  |
| 208 | 72  |
| 209 | 72  |
| 301 | 415 |
| 302 | 511 |
| 303 | 570 |
| 304 | 33  |
| 305 | 30  |
| 306 | 60  |

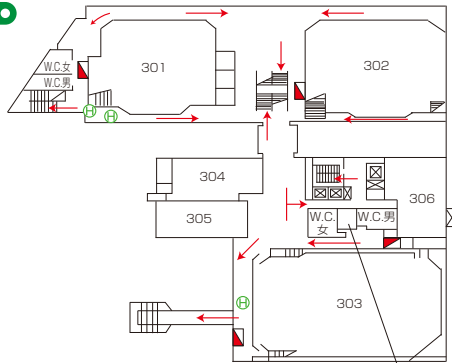
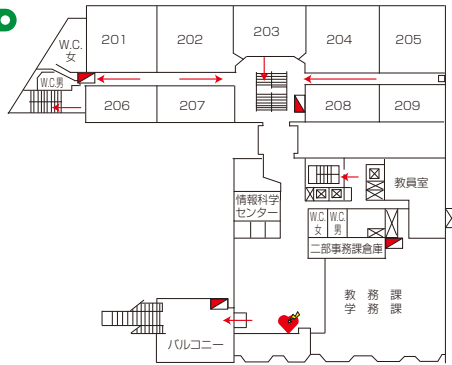

バリアフリー-W.C.

|       |  |
|-------|--|
| 消火栓   |  |
| 避難器具  |  |
| 避難    |  |
| A E D |  |

# 神田校舎 1～3号館 4階～15階

## 4階

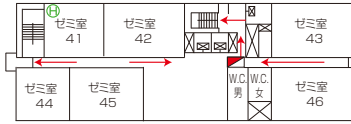

## 10階

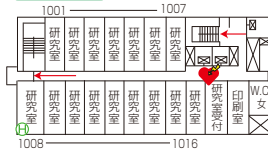

## 5階

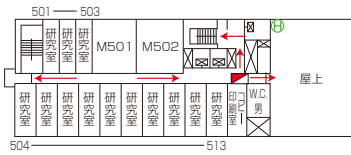

## 11階

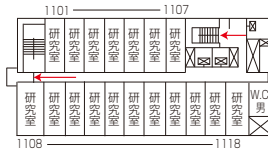

## 6階

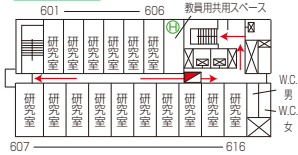

## 12階

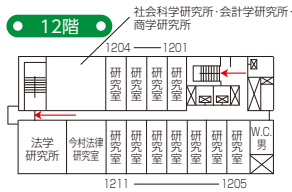

| 教室    | 定員 |
|-------|----|
| ゼミ室41 | 30 |
| ゼミ室42 | 42 |
| ゼミ室43 | 42 |
| ゼミ室44 | 33 |
| ゼミ室45 | 36 |
| ゼミ室46 | 36 |

## 7階

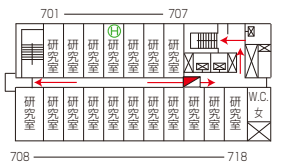

## 13階

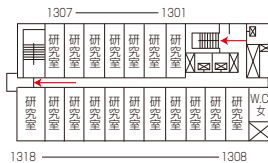

## 8階



## 14階

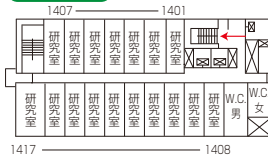

## 9階



## 15階



消火栓  
 避難器具  
 避難  
 AED